

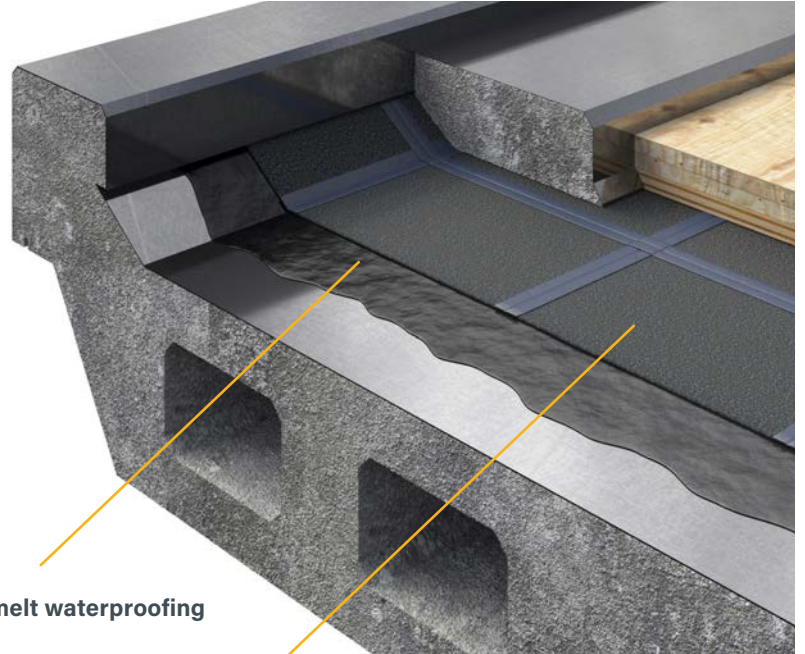

Servipak®

The Product

- **Robust Servipak Protection Boards** - prevent membrane damage from following trades and asphalt laying equipment
- **Proven performance** - over 25 years on road/rail bridges and trafficked decks.



Hot melt waterproofing

Servipak® boards with Armourtape™ E joints

Protection Boards to prevent membrane damage

Product Description

Servipak® protection boards are robust, bitumen impregnated boards, designed for permanent protection of the hot melt waterproofing. The boards are laid into the 'wet' hot melt liquid membrane to provide protection against damage from hot and cold applied finishes.

Applications

New and remedial waterproofing of:

- Road Bridges
- Rail bridges
- Elevated trafficked decks
- Car park roofs

System Components

- **Servipak®** - bitumen protection boards, available in 3 mm, 6 mm and 12 mm thicknesses

- **Armourtape™ E** is a rubber/bitumen self adhesive tape with a bituminous facing. Used for taping and sealing butt joints between Servipak protection boards
- **S2 Primer** is a solvented bitumen primer for use with Armourtape, when taping and sealing butt joints in Servipak boards.

Design

- Concrete decks should be designed and built in accordance with BS EN 1992-1-1: 2004 and its UK National Annex.
- Servidek/Servipak is satisfactory for use on trafficked decks subject to vehicular and pedestrian traffic. The system must be overlaid with a suitable wearing course, e.g. asphalt, concrete, paving slabs, block pavers, etc.
- Servidek/Servipak can be used on concrete or steel substrates.

** Details shown are typical illustrations only and not working drawings. For assistance with working drawings and additional technical advice please contact InStar Technical Services.*





Installation

Day joints

Always leave a 50 mm leading edge of hot melt compound to enable subsequent overlapping. Seal the exposed edges of Servipak protection boards with hot melt compound. Commence work the following day by ensuring the 50 mm leading edge is clean and dry, then overlap with fresh hot melt compound.

Servipak protection boards must be laid while the hot melt compound is still wet and laid progressively to minimise applicator trafficking until the hot melt has cured. The boards must be close butt jointed to ensure continuous protection to the hot melt. Where gaps occur between boards, these must be filled with hot melt prior to applying Armourtape to all board joints.

Where Servipak boards abut the parapet, pipe bays or abutments they should be pre-measured, and accurately cut to size by incising with a sharp knife and breaking on edge. The joints between the Servipak boards should be dry and primed with S2 Primer.

Apply primer in 100 mm wide bands with a brush or roller and allow to dry before applying self-adhesive Armourtape centrally over the joint. Careful application of heat will assist in promoting adhesion of the Armourtape at low temperatures.

For taping joints below cold applied finishes use Perm-A-Barrier Detail Membrane. See separate data sheet.

Armourtape must be firmly rolled with a lap roller along its length

and at junctions to ensure continuity. It is advisable to seal the exposed edge of the Servipak boards at the end of each working period to prevent the ingress of moisture overnight, by tooling the Servidek compound against the exposed edge of the Servipak boards.

Minimum cure time for hot melt/Servipak is 4 hours, after which bridge surfacing or trafficable deck finishes should be applied as soon as possible. It is good practice to ensure that the Servipak boards are fully bonded to the Servidek by firmly rolling with a heavy hand roller before final application of deck finishes.

Suitable Overlays/Wearing Courses

Full thickness overlays can be laid 30 days after the waterproofing is installed. hot melt/Servipak is designed to be self - protecting during the installation of all conventional bridge and trafficked deck structure overlays and wearing courses, including:

- Mastic asphalt to EN 13375: 2004
- Gussasphalt
- Coarse bituminous mixture (CBM) to EN 13375: 2004
- Reinforced concrete
- Pre-cast concrete paving slabs on bedding or pads
- Stone ballast (12 mm Servipak protection boards only)

Asphalt should be laid on hot melt/Servipak at a minimum placement temperature of +145°C and a maximum placement temperature of 185°C. In the event of ambient application temperature exceeding +30°C it may be necessary to restrict machine placement of asphalt finishes to cooler periods of the day.

Product description

Products	MTP1
Servipak 3	3 mm x 2 m x 1 m (2 m ²) - weight 12 kg/board (100 boards/pallet)
Servipak 6	6 mm x 2 m x 1 m (2 m ²) - weight 21 kg/board (50 boards/pallet)
Servipak 12	12 mm x 2 m x 1 m (2 m ²) - approx. weight 28 kg/board (25 boards/pallet)
Storage	Servipak may be stored outside but should be kept flat on original pallets
Armourtape™ E	75 mm x 20 m roll - 7 rolls/carton - 16.8 kg per carton
S2 Primer	5 litre drums (Coverage - 10 m ² per litre)
Ancillary products	
Bituthene® Mastic	4.5 litre can - weight 6.5 kg/unit
Serviseal® Type B	230 mm wide PVC extrusion for buried expansion joints. Supplied in 15 m rolls - 25 kg/roll
Bitustik™ 4000	Double sided tape 150 mm x 12 m rolls - 6 rolls/carton - 21 kg/carton
Colflex HN	Buried movement joints - see separate data sheet