



ProfilDeck® Sub-frame System

Tools

Minimal Tools Required

- Tape measure
- Level
- Screwdriver
- Electric mitre saw

Also recommended:

- A metal file
- Chalk or line marking spray



Safety Information:
Use Protective Glasses and
Safety Gloves

1. Site Preparation

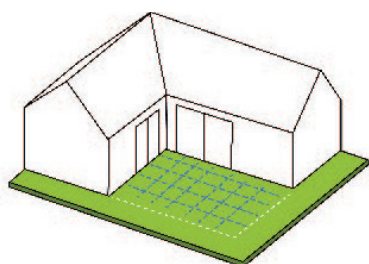
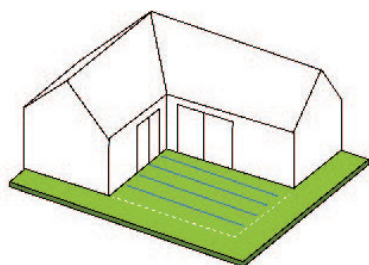
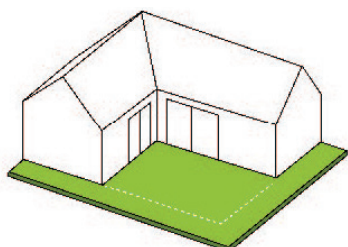

Before starting:

- Work out the pattern of the terrace with consideration for
- Tile cuts
- Spacing
- Quantity of pedestals, junction tabs, angle brackets , profiles.

Site Preparation

- Firstly, define the area for the installation and sweep the ground removing stones.
- Mark on the ground the position of the profiles using chalk or line marking spray.

For paving installation, the distance between the profiles is determined by the size of the tiles.

- Mark on the ground the position of pedestal risers, according the spacing guidelines, using chalk or line marking spray.

For paving installation, the recommended spacing is 80 cm between the pedestals.

When laying parallel profiles, ensure there is a pedestal underneath the connection points. The others should be placed at the recommended spacing.



2. Assembling

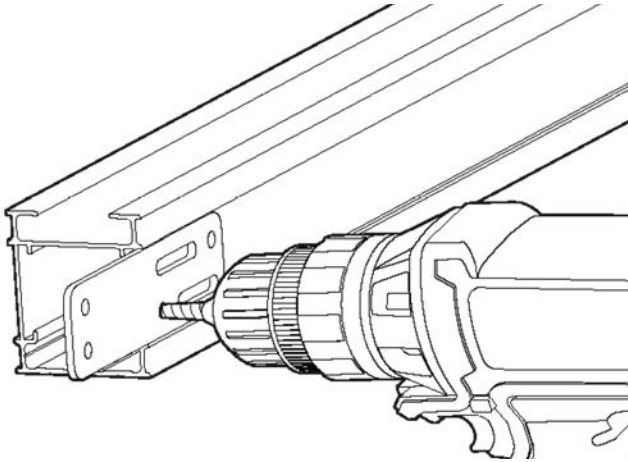

To assemble the frame, use the junction tab along with the horizontal and vertical angle brackets.

Tools: screwdriver and level.

- If the installation is longer than 3 metres, you can easily connect two profiles - Connect the profile lengths using junction tab and Profildeck screws.
- Place junction tab outside the profile.
- Pre-drill using the junction tab as a template.
- Pre-drill through holes using a 4 mm metal drill.
- Slide the 1st junction tab inside the profile and fix with 2 screws.
- Slide the 2nd junction tab inside the profile and fix with 2 screws.
- Ensure there is a 1 mm gap between the two profiles.

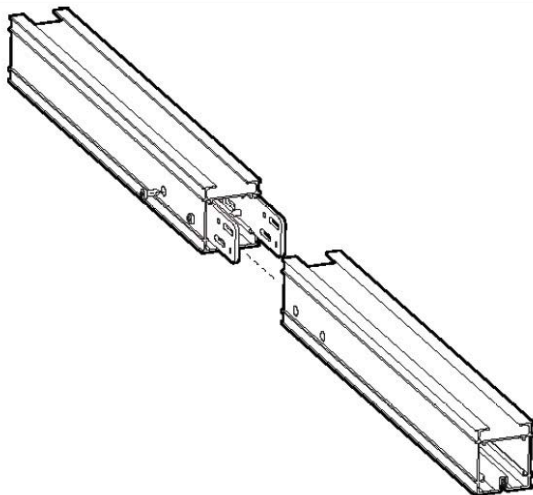

- Slide the 1st junction tab inside the profile and fix with 2 screws.
- Slide the 2nd junction tab inside the profile and fix with 2 screws.
- Ensure there is a 1 mm gap between the two profiles.

Using a horizontal junction angle bracket:

- To connect noggins.
- To create a U shape or L shape installation.
- Place horizontal junction bracket outside the profile.
- Fix with 2 screws using the slotted holes.
- Fix using a ProfilDeck® screw 4.8 x 19 mm tightened to a torque of 2.5n. (The tightening torque is 8 on 20 for an 18 volts screwdriver).

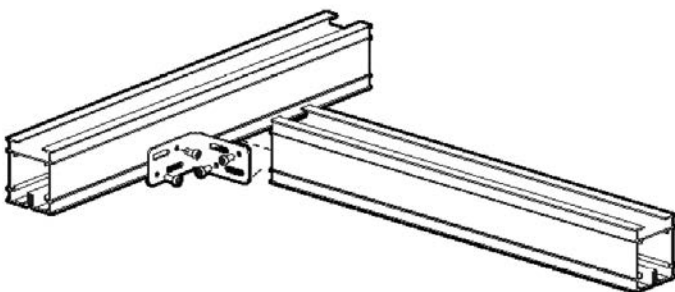



3. Pedestal Risers Installation

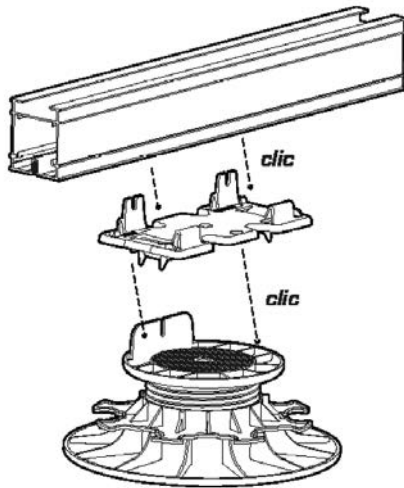

Place the pedestals on the marked positions on the ground.

- Clip the adaptor onto the top of the pedestal.
- Begin with the corner pedestals to level the sub-frame and then lay and level the others.
 - When laying parallel profiles always ensure there is a pedestal underneath the connections points along with pedestals at the recommended spacing.
 - When installing with noggins lay the pedestal at the recommended spacing.
- Clip the profile to the adaptor.
- Connect the adaptor to the profile using the two notches and 2 Profildeck screws. One fixing at each end of the length is enough.
- Use the nut on the pedestal to simply adjust to the desired height.

4. Finishing

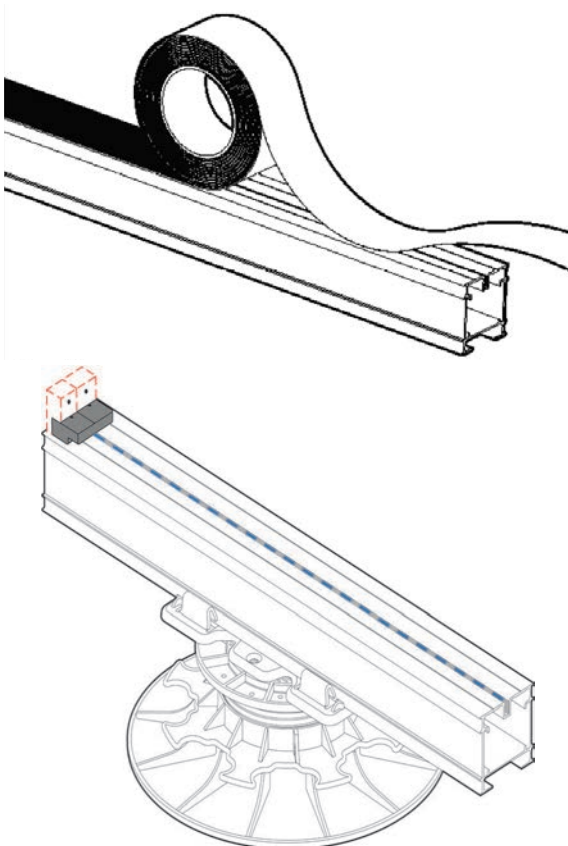

FOR DECKING:

- Lay the boards or the tiles according the defined pattern.
- Apply the decking cover tape on the decking side of the aluminium profile (Ensure surface is clean and dry before application). For best results, peel off the backing strip progressively as you apply the tape.
- Lay the decking leaving a consistent space between the boards. Fix using a 5.5 x 45 mm screw and tighten to max of 7n torque. (The tightening torque is 18 on 20 for an 18 volts screwdriver).
- If using the invisible fixing system FixeGo®.
 - Place a cleat at the end of each profile, the cleat should be at the centre of the profile and positioned 5 mm in from the end.
 - Pre drill with a 3 mm metal drill.
 - The tightening torque is 10 on 20 for an 18 volts screwdriver.
 - Fix the cleat with a 4 x 25 mm screw (supplied in Fixego kit).

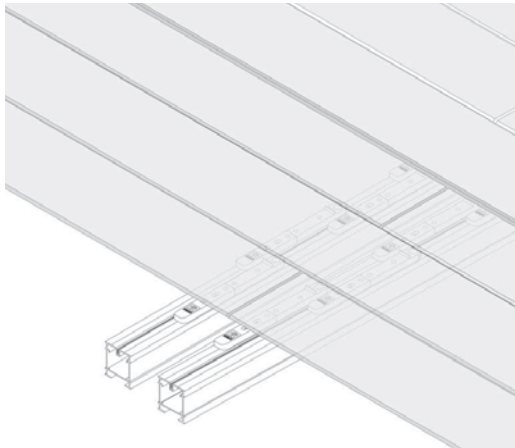

- When butting up deck boards it is recommended to use two noggins on the sub frame. One noggin to support the end of the first deck board and the second to support the beginning of the next.
- The 6 x 30 mm screws for Fixego are included in the Fixego kit.
- Pre-drill with a 4 mm metal drill.
- The tightening torque is 15 on 20 for an 18 volts screwdriver.

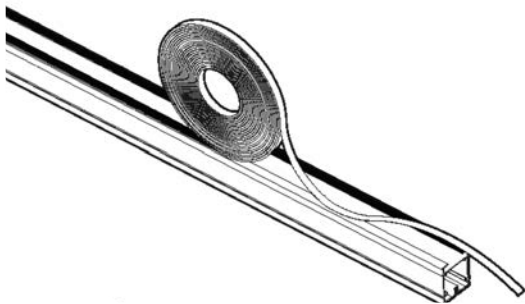

FOR PAVING:

- Apply the rubber tape on the paving side of the aluminium profile (ensure surface is clean and dry before application). For best results peel off the backing strip progressively as you apply the tape.

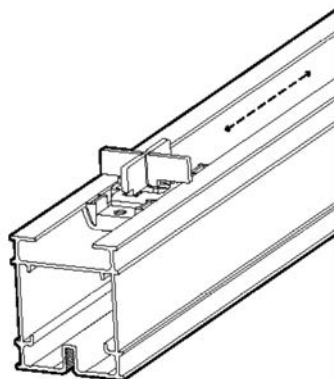
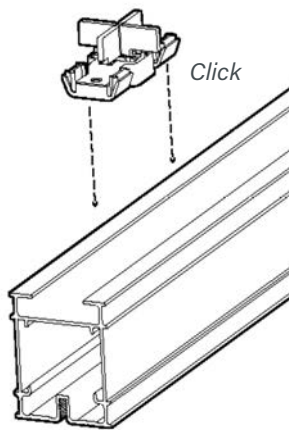

- Insert the spacer on the paving side of the profile.
- For a staggered tile installation, the spacers can be easily split.
- Lay the tiles.

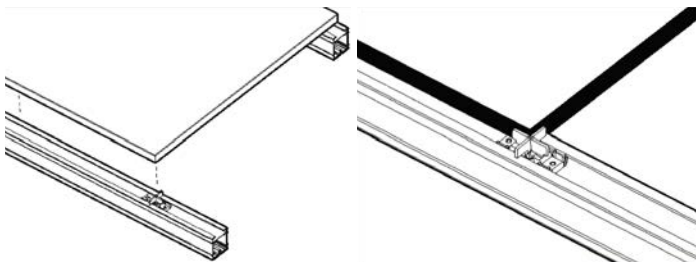



6. Additional Options

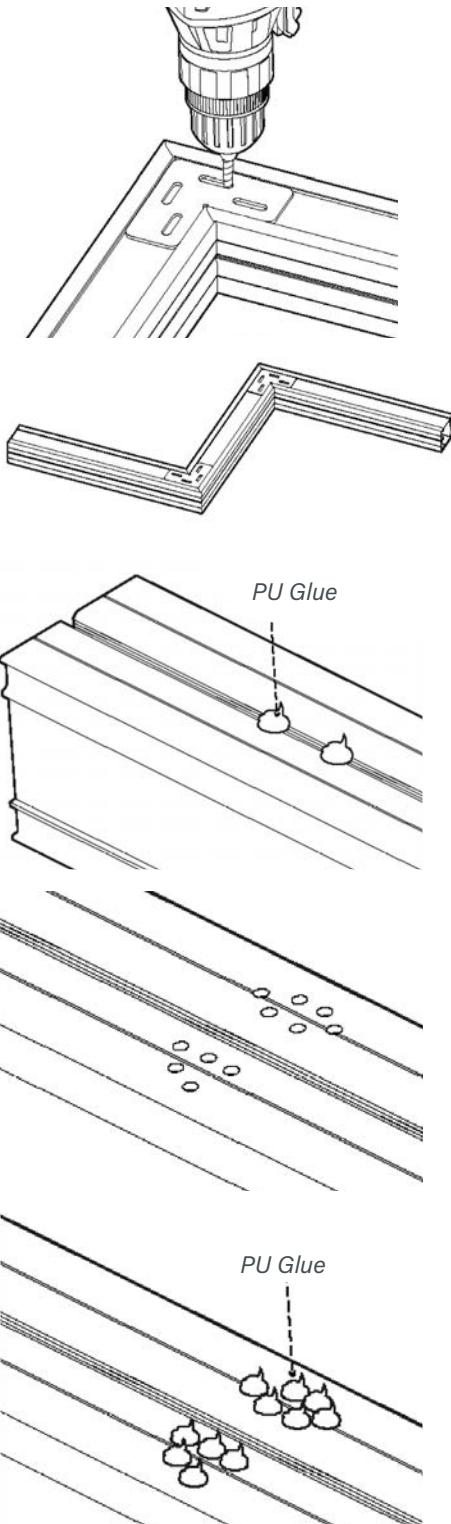

HOW TO CREATE A STEP

- Cut the profile at 45 degrees angle.
- Place a vertical junction angle bracket (outside the profile).
- Screw using the slotted holes and fix with the Profildeck® screw 4.8 x 19 mm.

HOW TO CREATE A STAIR RISER (2 OPTIONS):

On the decking side:

- Either, put some polyurethane glue on the central rail / channel/ groove.
- Or, drill 5 holes with a 4 mm metal drill. Put some polyurethane glue on the holes. Then, place the stair riser and press.